



Accessories
Multilayer

05

多层管
卡压式管件
Accessories
Multilayer

Accessories Multilayer



多层管卡压式管件 Press Fittings for Multilayer Pipe

西班牙AENOR认证产品, 认证号码: 001/005920
AENOR certified products in Spain,
certification no.: 001/005920

配件和材料
Parts and Material

主体: CW617N或CW614N符合UNE-EN ISO 21003
Body: CW617N or CW614N, in accordance with UNE-EN ISO 21003

卡圈: AISI 304
Ring: AISI 304

O型圈: 三元乙丙
O-ring: EPDM

卡圈保护座: 聚丙烯
Ring protective seat: PP

SISTEMA CERTIFICADO
CON MARCA AENOR

Ø 16x2, 18x2, 20x2, 25x2,5, 32x3 Clase 1-2-4-5/6 bar



优势 Superiority

产品头部锯齿状的设计确保了管材和管件紧密完美的连接。
The serrated design of the head provides the perfect tight connection of the pipe and the fittings

头部倒角设计为水从管子到管件的流动提供了完美过渡, 既减少了水流阻力, 同时还减少了沉积物的沉淀。
The chamfer of the head part provides perfect transition for water flowing from the pipe to the fitting, which reduces water flow resistance and the sediments at the same time.

产品上的O型圈是70%三元乙丙过氧硫化的高压缩材质, 符合UNE EN681-1以及UNE EN 682-2标准, 因此可以确保产品完美的密封性。产品符合食品标准DVGW W270。

O-ring used on the fittings is made of peroxide vulcanizing high compression EPDM 70% in accordance with UNE EN681-1 and UNE EN 682-2, which can provide the perfect tightness for the product. It also meets requirements of DVGW W270 food standard.

卡圈原材料为304不锈钢, 根据机械挤压性设计而成, 上面印有管子的直径和厚度。为确保管材安装到位, 我们在卡圈上留了3个观察孔。

The ring is made of AISI 304, designed in accordance with the mechanical pressing formability and marked the diameter and thickness of the pipe. The ring has 3 observation holes to guarantee the proper installation of the pipe.

不锈钢卡圈保护套由聚丙烯制成, 它可以阻止电流通过铝塑管的铝层传到管件上, 同时也固定了卡圈, 确保了管材插入卡圈时可以轻松地进行卡压连接。

The ring protective seat is made of polypropylene, which can prevent the electricity conducting to the fittings through the aluminum layer and in the meantime fix the ring and provide easy press connection while the pipe inserts the ring.

Accessories Multilayer

CODE	SIZE	L	∅D	BOX/CTN
MCRMV 1612L	16-1/2"	43.3	25.8	25 / 300
MCRMV 1812L	18-1/2"	43.3	25.8	25 / 300
MCRMV 2012L	20-1/2"	43.3	25.8	25 / 300
MCRMV 2034L	20-3/4"	46.3	33.8	25 / 225
MCRMV 2534L	25-3/4"	54.8	33.8	25 / 225
MCRMV 251L	25-1"	64	40	25 / 150
MCRMV 321L	32-1"	64	40	25 / 150

CODE	SIZE	L	∅D	BOX/CTN
MCRFH1612	16-1/2"	39.5	30	25/300
MCRFH1634	16-3/4"	39.5	34	25/300
MCRFH1812	18-1/2"	39.5	30	25/300
MCRFH2012	20-1/2"	39.5	30	25/300
MCRFH2034	20-3/4"	39.5	34	25/225
MCRFH2512	25-1/2"	48	30	25/225
MCRFH2534	25-3/4"	48	34	25/225
MCRFH251	25-1"	52.5	42	25/225
MCRFH321	32-1"	52.5	42	25/150

CODE	SIZE	L	∅D	BOX/CTN
MCRFM1638	16-3/8"	43.5	24.5	25/300
MCRFM1612	16-1/2"	44	24.5	25/300
MCRFM1634	16-3/4"	44.5	30	25/225
MCRFM1812	18-1/2"	44	24.5	25/300
MCRFM2012	20-1/2"	44	24.5	25/300
MCRFM2034	20-3/4"	44.5	30	25/225
MCRFM2512	25-1/2"	53	30	25/225
MCRFM2534	25-3/4"	53	30	25/225
MCRFM251	25-1"	57	38.2	25/225
MCRFM321	32-1"	57	38.2	25/150

CODE	SIZE	L	∅D	BOX/CTN
MCMAU16	16-16	52	16	25/300
MCMAU18	18-18	52	19	25/300
MCMAU20	20-20	52	19	25/300
MCMAU25	25-25	69	22	25/225
MCMAU32	32-32	69	30	25/150

CODE	SIZE	L	∅D	BOX/CTN
MCMGR1816	18-16	52	19	25/300
MCMGR2016	20-16	52	19	25/300
MCMGR2018	20-18	52	19	25/300
MCMGR2516	25-16	60.5	22	25/225
MCMGR2520	25-20	60.5	22	25/225
MCMGR3220	32-20	60.5	30	25/150
MCMGR3225	32-25	69	30	25/150

Female Swivel Coupling · 内螺纹活接直通

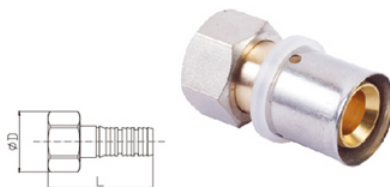

Female Coupling · 内螺纹直通



Male Coupling · 外螺纹直通

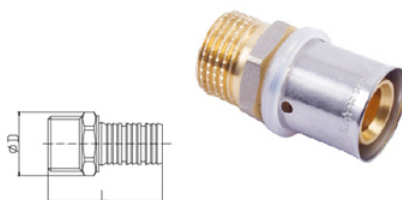

Equal Union · 等径直通



Reducing Union · 异径直通

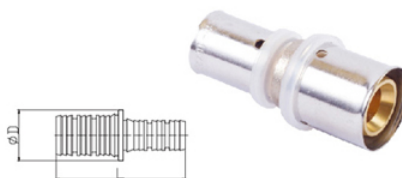

05

多层管
卡压式管件
Accessories
Multilayer

等径弯头 · Elbow

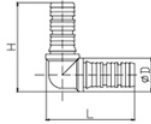

CODE	SIZE	L	H	$\varnothing D$	BOX/CTN
MCCD016	16-16	42.5	16	42.5	25/300
MCCD018	18-18	43.6	18	43.6	25/225
MCCD020	20-20	43.6	18	43.6	25/225
MCCD025	25-25	56.4	22	56.4	25/150
MCCD032	32-32	63	28	63	25/100

内螺纹弯头 · Female Elbow

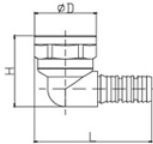

CODE	SIZE	L	H	$\varnothing D$	BOX/CTN
MCCOT1612	16-1/2"	51	31.5	26	25/300
MCCOT1612R	16-1/2"	53	32	28	25/225
MCCOT1812R	18-1/2"	53	32	28	25/225
MCCOT2012	20-1/2"	51	31.5	26	25/225
MCCOT2012R	20-1/2"	53	33.5	28	25/225
MCCOT2034	20-3/4"	58	39.5	34	25/225
MCCOT2512	25-1/2"	63	36.5	28	25/150
MCCOT251	25-1"	76	48	41	25/150
MCCOT2534	25-3/4"	76	40.5	34	25/150
MCCOT321	32-1"	76	48	41	25/100

带座内螺纹弯头 · Wallplate Female Elbow

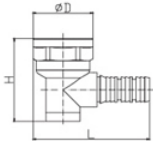

CODE	SIZE	L	H	$\varnothing D$	BOX/CTN
MCCCC1612	16-1/2"	51.5	35.5	26	25/225
MCCCC1612R	16-1/2"	53.5	38	28	25/225
MCCCC1812R	18-1/2"	53.5	42	28	25/225
MCCCC2012	20-1/2"	51.5	38.5	26	25/225
MCCCC2012R	20-1/2"	53.5	42	28	25/225
MCCCC2034	20-3/4"	58.5	41	34	25/225
MCCCC2534	25-3/4"	67	44	34	25/100

外螺纹弯头 · Male Elbow

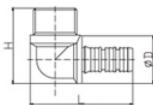

CODE	SIZE	L	H	$\varnothing D$	BOX/CTN
MCCRM1612	16-1/2"	49.5	38.5	16	25/300
MCCRM1812	18-1/2"	49.5	38.5	18	25/300
MCCRM2012	20-1/2"	49.5	38.5	18	25/300
MCCRM2034	20-3/4"	55.5	41.5	18	25/225
MCCRM2534	25-3/4"	64	44	22	25/225
MCCRM321	32-1"	70	51.5	28	25/150

Accessories Multilayer

Equal Tee · 等径三通

CODE	SIZE	L	H	øD	BOX/CTN
MCTEE16166	16-16-16	68.2	42.1	16	25/225
MCTEE18188	18-18-18	69.5	43.6	18	25/225
MCTEE20200	20-20-20	69.5	43.6	18	25/225
MCTEE25255	25-25-25	94	58	22	25/100
MCTEE32323	32-32-32	100	64	28	25/80

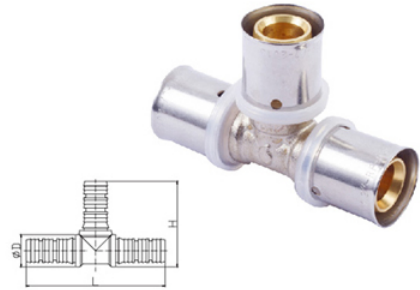

Reducing Tee · 异径三通

CODE	SIZE	L	H	øD	BOX/CTN
MCTEE16206	16-20-16	69.5	43.6	18	25/225
MCTEE16256	16-25-16	77	58	22	25/225
MCTEE18166	18-16-16	69.5	43.6	18	25/225
MCTEE20160	20-16-20	69.5	43.6	18	25/225
MCTEE20166	20-16-16	69.5	43.6	18	25/225
MCTEE20180	20-18-20	69.5	43.6	18	25/225
MCTEE20206	20-20-16	69.5	43.6	18	25/225
MCTEE20250	20-25-20	77	58	22	25/150
MCTEE25160	25-16-20	75.5	49.5	22	25/150
MCTEE25165	25-16-25	84	49.5	22	25/150
MCTEE25185	25-18-25	87	49.5	22	25/150
MCTEE25206	25-20-16	78.5	49.5	22	25/150
MCTEE25200	25-20-20	78.5	49.5	22	25/100
MCTEE25205	25-20-25	87	49.5	22	25/100
MCTEE25250	25-25-20	85.5	58	22	25/100
MCTEE32163	32-16-32	89	54	28	25/100
MCTEE32203	32-20-32	89	54	28	25/100
MCTEE32253	32-25-32	89	63	28	25/100
MCTEE32255	32-25-25	89	63	28	25/100
MCTEE32325	32-32-25	100	64	28	25/100

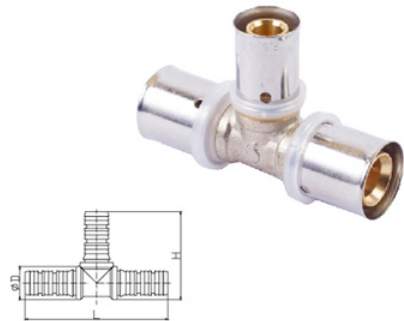

Female Tee · 内螺纹三通

CODE	SIZE	L	H	øD	BOX/CTN
MCTSH1612R	16-1/2"-16	78	31	28	25/225
MCTSH1812R	18-1/2"-18	78	32	28	25/225
MCTSH2012R	20-1/2"-20	78	32	28	25/225
MCTSH2534	25-3/4"-25	99	40.5	34	25/150
MCTSH321	32-1"-32	107	49	41	25/80

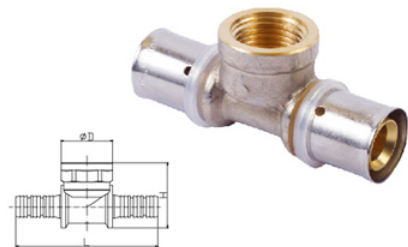

05

多层管
卡压式管件
Accessories
Multilayer

五通 · Manifold



CODE	SIZE	L	H	øD	BOX/CTN
MCDIS2520163	25-20-16-16-16	79	118	30	25/80
MCDIS2020163	20-20-16-16-16	79	109.5	30	25/80
MCDIS2020162	20-20-16-16	79	109.5	30	25/80

四通 · Cross



CODE	SIZE	L	H	øD	BOX/CTN
MCCR20201616	20-20-16-16	73	73	20	25/100
MCCR25201616	25-20-16-16	87.5	79	25	25/100
MCCR25202020	25-20-20-20	87.5	79	25	25/100
MCCR20162016	20-16-20-16	73	73	20	25/100
MCCR25162016	25-16-20-16	87.5	79	25	25/100

带紫铜管弯头 · Radiator Cu Elbow



CODE	SIZE	L	H	øD	BOX/CTN
MCCTR1615	16-15	46.5	35	21	20/80

堵头 · Plug



CODE	SIZE	L	øD	BOX/CTN
MCTPRES16	16	27.5	16	50/600
MCTPRES18	18	27.5	19	50/600
MCTPRES20	20	27.5	19	50/600

接紫铜管直通 · Copper Coupling

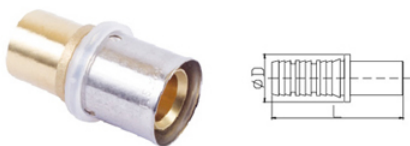

CODE	SIZE	L	øD	BOX/CTN
MCAPE1625	16-CU12	41.3	17	25/300
MCAPE1615	16-CU15	41.3	20	25/300
MCAPE2058	20-CU15	41.3	20	25/300

Accessories Multilayer

CODE	SIZE	L	H	∅D	BOX/CTN
MCVMP16	16-16	63	90.5	26.5	1/48
MCVMP20	20-20	63	90.5	26.5	1/48
MCVMP25	25-25	116	98	33	1/48

Shutoff Valve Concealed Lockshield · 暗装截止阀

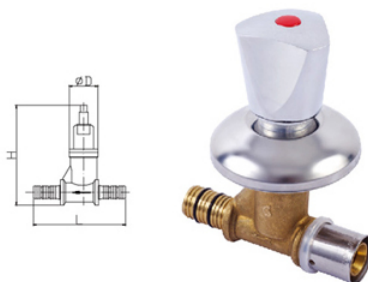

CODE	SIZE	L	H	∅D	BOX/CTN
MCVMRO 16	16-16	63	90.5	26.5	1/48
MCVMRO 20	20-20	63	90.5	26.5	1/48
MCVMRO 25	25-25	116	98	33	1/48

Shutoff Valve Concealed Lockshield · 暗装截止阀

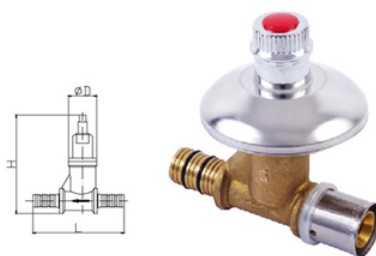

05
多层管
卡压式管件
Accessories
Multilayer

CODE	SIZE	BOX/CTN
ALARGVMPCD	16, 20, 25	25

Extension · 加长杆



Plug · 堵头

CODE	SIZE	BOX/CTN
MCTAPON 16	16	25 / 300
MCTAPON 18	18	25 / 300
MCTAPON 20	20	25 / 300

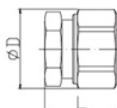

Ring · 卡圈

CODE	SIZE	BOX/CTN
MCCSA 16	16	25 / 600
MCCSA 18	18	25 / 600
MCCSA 20	20	25 / 600
MCCSA 25	25	25 / 450
MCCSA 32	32	25 / 300

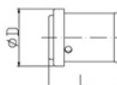

暗装球阀 · Ball Valve

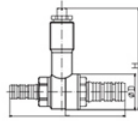

CODE	SIZE	L	H	øD	BOX/CTN
MCESF16	16-16	89	85	30.5	1/48
MCESF20	20-20	89	85	30.5	1/48
MCESF25	25-25	103.5	89.5	34	1/48
MCESF32	32-32	123.5	100	45	1/48

暗装带座球阀 · Ball Valve

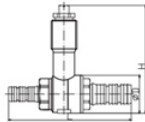

CODE	SIZE	L	H	øD	BOX/CTN
MCESFBF20	20-20	89	85	30.5	1/48
MCESFBF25	25-25	112	93	38	1/48

暗装U型球阀 · Ball Valve "U"

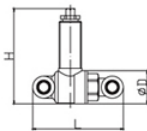

CODE	SIZE	L	H	øD	BOX/CTN
MCU16	16-16	82	86	30.5	2/80
MCU20	16-16	82	86	30.5	2/80
MCU25	16-16	98	89.5	34	2/80

Nut kit isn't included in the the valve.

CODE	DESCRIPTION	PCS/BOX
KTU	Nut Kit	1/2

球阀 · Ball Valve

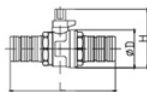

CODE	SIZE	L	H	øD	BOX/CTN
VEMC16	16-16	88	48	30	1/100
VEMC20	20-20	88	48	30	1/100
VEMC25	25-25	105	51	34	1/80
VEMC32	32-32	106	57	38	1/80

Accessories Multilayer

多层管与卡压式管件的安装

Installation instruction of multilayer pipe and press fittings with ss ring

1 剪管 Cut the pipe



用剪刀将管材剪下一小节，确保切口尽可能干净垂直
Cut a section of the pipe with scissors, and make sure the cut is neat and perpendicular.

2 校正管材 Calibrate the cut of the pipe



将倒角器插入管中，到达与该管尺寸相对应的位置。
顺时针方向旋转倒角器，确保管口倒角完全倒好。
Insert the calibrator to the pipe till the relevant position of this sized pipe. Rotate the calibrator clockwise till the cut of the pipe is well chamfered.

3 连接管件 Insert the fittings



将正确尺寸的管件插入管材中。因管件上已配卡圈与密封圈，则安装过程中需轻轻旋转管件，从卡圈上的观察孔看到管材已插到位。

Insert the correct sized fittings to the pipe. As the fittings already assembled the ring and seats, therefore, during the installation the fittings must be rotated into the pipe lightly till pipe reaches the right position by viewing from the observation hole on the ring.

4 卡压 Press the fittings



效果
Result



将RF工具中配置的相应管件尺寸的模块装入工具，然后将插好管材的管件放入模块中，卡压并确保模块完全合拢。

Choose the die of fittings size from the RF tool and place it in the tool, then put the fittings which has already inserted to the pipe in the die and press the tool till the die closed completely.

05

多层管
卡压式管件
Accessories
Multilayer